

CONTROL NOTES

1. **HORIZONTAL DATUM:** COORDINATE POSITIONS SHOWN ARE *WASHINGTON STATE PLANE (NORTH ZONE) NAD83/2007* GRID VALUES, BASED UPON HOLDING THE PUBLISHED COORDINATES FOR *ISLAND COUNTY SURVEY CONTROL POINT #1027*, A CAPPED REBAR FLUSH WITH THE GROUND NORTH OF SEASHORE AVENUE APPROXIMATELY 100 FEET EAST OF THE MARINA BOAT LAUNCH, AS EXPRESSED IN THE CURRENT 2007 EPOCH OF NAD83 . THE SURVEY CONTROL POINT WAS SET BY ISLAND COUNTY IN 2007, AND HAS AN ESTIMATED HORIZONTAL AMBIGUITY OF 2CM AND AN ESTIMATED VERTICAL AMBIGUITY OF 5CM. PUBLISHED VALUES HELD FOR THIS SURVEY.

2. **VERTICAL DATUM:** ELEVATIONS SHOWN ARE REFERENCED TO THE *NOAA/TIDAL MLLW = 0.00'* DATUM, BASED UPON HOLDING THE PUBLISHED NAVD88 ELEVATION AT *ISLAND COUNTY SURVEY CONTROL POINT #1027*. CONVERSIONS FROM THE PUBISHED NAVD88 VALUE TO LOCAL TIDAL (MLLW = 0.00') DERIVED USING THE CURRENT (V. 3.2) VERSDION OF NOAA'S TIDAL-DATUM CONVERSION SOFTWARE "VDATUM" FOR THE PUGET SOUND REGION. VERTICAL CONVERSION FROM *NAVD88 TO MLLW*, PER THE CURRENT MENSURATION IS **+1.15'**. THAT IS, TO CONVERT A VALUE EXPRESSED IN NAVD88 TO ITS VALUE RELATIVE TO THE MLLW DATUM, **1.15 FEET SHOULD BE ADDED TO THE NAVD88 VALUE**. (A MONUMENT HAVING A NAVD88 ELEVATION OF 10.00', WOULD HAVE A MLLW ELEVATION OF 11.15', FOR EXAMPLE.)

3. **BASIS OF COORDINATES:** LOCAL CONTROL AND TOPOGRAPHY IS BASED UPON HOLDING THE CURRENT NAD83(2007) COORDINATE VALUES FOR ISLAND COUNTY SURVEY CONTROL POINT #1027. THE MARK IS A REBAR AND RED PLASTIC CAP SET NORTH OF SEASHORE AVENUE EAST OF THE BOAT LAUNCH RAMP. THE COORDINATES FOR SAID MONUMENT ARE AS FOLLOWS:

NORTHING = 398,690.120 USFT
EASTING = 1,205,853.450 USFT

4. **BASIS OF BEARINGS:** BEARINGS FOR LOCAL CONTROL AND BATHYMETRY ARE *WASHINGTON STATE PLANE (NORTH ZONE) GRID*, BASED UPON HOLDING THE GPS-DERIVED INVERSE BETWEEN ISLAND COUNTY CONTROL POINT #1027, AND WILSON CONTROL POINT #1004 , A CASED BRASS DISK MONUMENT MARKING THE SUBDIVISIONAL LINE BETWEEN THE LAGOON POINT PLATS, AND THE SOUTH LINE OF THE LAGOON POINT COMMUNITY WATERWAY. PER CURRENT RTK/VRS MEASUREMENT THE DERIVED INVERSE BEARING BETWEEN *ISLAND COUNTY #1027* AND *WSE #1004* IS **S 66°40' 47" E** A DISTANCE OF **709.35 FEET**. THE MEASURED COORDINATES FOR *WSE #1004* ARE AS FOLLOWS:

NORTHING = 398,409.310 USFT
EASTING = 1,206,504.850 USFT

5. **BASIS OF ELEVATIONS:** THE PUBLISHED NAVD88 ELEVATION FOR ISLAND COUNTY *CONTROL POINT #1027* WAS HELD AS AUTHORITATIVE AS PUBLISHED. NAVD88 ELEVATION AND CONVERSIONS PER VDATUM FOR #1027 ARE AS FOLLOWS:

NAVD88 ELEVATION: 10.97 FEET
MLLW ELEVATION: 12.12 FEET
NGVD29 ELEVATION: 7.29 FEET

6. **SITE BENCHMARKS:**
TBM "A": WILSON CONTROL POINT #1010, AN IRON TABLET NEAR THE TOP OF THE CONCRETE BOAT LAUNCH STAMPED "ELEV. = 10.41". PER WILSON CLOSED LEVEL LOOP ,THE *MLLW* ELEVATION AT CONTROL POINT #1010 IS: **13.81 FEET**. (THE NAVD88 ELEVATION FOR #1010 IS 12.66 FEET.)
TBM "B": A BERNTSEN SURVEY SPIKE SET IN THE EAST SIDE OF THE SOUTHERNMOST PILING AT THE BOAT LAUNCH FLOAT PER WILSON CLOSED LEVEL LOOP ,THE *MLLW* ELEVATION AT TBM "B" IS: **14.86 FEET**. (THE NAVD88 ELEVATION FOR TBM "B" IS 13.71 FEET.)

SURVEY NOTES

1. THE SURVEY HEREON DEPICTED WAS PERFORMED IN MARCH, 2017, AND WAS PREPARED AT THE REQUEST OF THE LAGOON POINT HOOMEOWNERS' ASSOCIATION AND THE LAGOON POINT ARCHITECTURAL COMMITTEE. IT IS INTENDED TO ACCURATELY CHARACTERIZE THE BATHYMETRIC CONTOURS AND FEATURES OF THREE (3) DISTINCT ELEMENTS, BEING THE ENTRANCE CHANNEL FROM ADMIRALTY INLET, THE RECENTLY-DREDGED MAIN BASIN, AND THE TWO CHANNELS LYING SOUTH OF THE COMMUNITY WATERWAY LINE. WITHIN THE SCOPE OF THE TWO SOUTH CHANNELS, DATA WAS COLLECTED ASSIDUOUSLY BETWEEN THE CHANNEL-SIDE FACES OF THE FLOATING DOCKS, AND INFREQUENTLY FROM THAT FACE SHOREWARD.

2. SHEETS NO. 2 AND NO.6 DEPICT THE 2013 "COMPARISON SURFACE LIMIT" FROM WHICH VOLUMETRIC CHANGE HAS BEEN CALCULATED. THIS LINE REPRESENTS THE LIMIT OF THE BATHYMETRIC SURFACE PREPARED IN 2013 ACCORDING TO THE "131345V00-POST DREDGE", DRAWING PREPARED BY WILSON FOR THE LAGOON POINT HOMEOWNERS' ASSOCIATION. THE VOLUME COMPARISON OF THE PREVIOUS, AND CURRENT, SURFACES SHOWS A NET FILL FOR THE STUDY AREA OF **+2,820 (RAW) CUBIC YARDS, +/- 715 CUBIC YARDS**.

3. THIS SURVEY MEETS OR EXCEEDS THE METHODOLOGY AND ACCURACY REQUIREMENTS FOR A U.S.A.C.E CLASS I HYDROGRAPHIC SURVEY. HYDROGRAPHIC/BATHYMETRIC DATA WAS COLLECTED USING *TRIMBLE 5700* SURVEY-GRADE GPS RECEIVERS OPERATING IN REAL-TIME KINEMATIC MODE, FOR CONTROL OF POSITION, HEADING, AND TRANSDUCER ELEVATION. DEPTH SOUNDINGS WERE ACQUIRED USING AN *OHMEX SONARMITE* SURVEY-GRADE FATHOMETER OPERATING AT A FREQUENCY OF 210kHz, WITH A 2hz SAMPLE RATE. SOUND VELOCITY CORRECTIONS FOR THE WATER COLUMN WERE RECORDED USING A *VALEPORT SOUNDBAR II* SOUND VELOCITY PROFILER. HYDROGRAPHIC DATA WAS COMPILED, ANALYZED, VALIDATED, AND THINNED USING *HYPACK 2012A* HYDROGRAPHIC MAPPING SOFTWARE. FINAL ADJUSTMENTS TO CORRECT FOR TRANSDUCER REFERENCE FACTOR, AND CONVERSION TO MLLW DATUM WERE PERFORMED USING *CIVIL3D* CIVIL ENGINEERING SOFTWARE. SPOT ELEVATIONS SHOWN ON THIS MAP REPRESENT APPROXIMATELY 4% OF THE DATA ORIGINALLY COLLECTED, AND APPROXIMATELY 40% OF THE DATA POINTS USED TO GENERATE THE "EXISTING CONDITIONS" SURFACE FOR VOLUME CALCULATIONS.

4. QUALITY CONTROL BARCHHECKS FOR THIS SURVEY WERE PERFORMED AT THE BEGINNING AND END OF SURVEY DATA COLLECTION. DIRECT-MEASURE GROUND TRUTH AS MEASURED AGAINST CONVERTED SOUNDING DATA WAS COLLECTED AT A VARIETY OF DEPTHS, AND LOCATIONS. VARIATION BETWEEN CONVENTIONAL ASBUILT VALUE AND BATHYMETRIC SURVEY DATA WAS FOUND TO BE LESS THAN OR EQUAL TO 0.10'.

5. THIS SURVEY IS INTENDED TO ACCURATELY REPRESENT THE SUBMERGED TOPOGRAPHY WITHIN THE BASINS AND CHANNELS OF THE LAGOON POINT MARINA. DATA WAS COLLECTED IN THE CHANNELS BETWEEN THE WATERWARD FACES OF THE DOCK STRUCTURES AND, WHERE POSSIBLE, BEHIND THE EXTANT DOCKS, HOWEVER, ANY DATA REPRESENTED SHOREWARD OF THE OUTSIDE FACES OF DOCKS SHOULD BE CONSIDERED APPROXIMATE IN CHARACTER, DUE TO SCARCITY OF INFORMATION. THE STRUCTURES DEPICTED HEREON ARE INTENDED TO PROVIDE VISUAL REFERENCE POINTS FOR THE CONTOUR INFORMATION, BUT ARE NOT AN AUTHORITATIVE AS-BUILT OF THE STRUCTURES. CONSIDER THE LOCATIONS OF FLOATS, DOCKS, AND RAMPS TO BE SCHEMATIC ONLY.

6. THE LINE SEGREGATING THE PLAT OF LAGOON POINT FROM THE PLAT OF LAGOON POINT No.2-- AND MARKING THE SOUTH MARGIN OF THE LAGOON POINT COMMUNITY WATERWAY-- COMMENCES AT THE POINT #1004, DERIVED BY DIRECT MEASURE OF THE CASED BRASS DISK MONUMENT AT THE CENTERLINE OF SHOREWOOD AVENUE AND SHOWN ON THE FACE OF BOTH PLATS. THE WEST EXTENSION OF SAID WATERWAY LINE WAS CALCULATED USING PLAT VALUE MEASUREMENT FROM TWO FOUND CASED BRASS DISK MONUMENTS NEAR THE NORTH CUL-DE-SAC OF OCEAN SIDE DRIVE, AS SHOWN ON THE PLAT OF LAGOON POINT No.2.

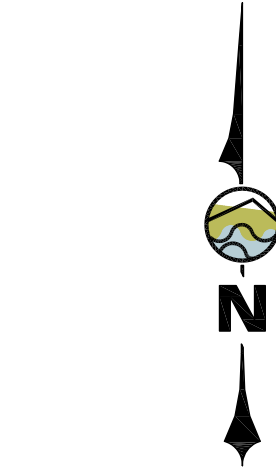

DATUM CONVERSION SCALE
(PER NOAA STATION DATA SHEET #9444900)

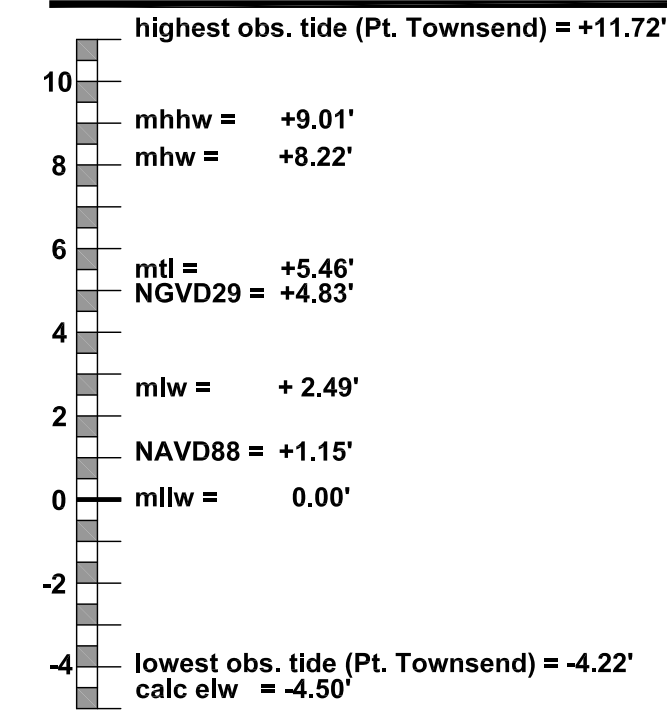

Elevations Table			
Number	Minimum Elevation	Maximum Elevation	Color
1	-121	-18	
2	-18	-15	
3	-15	-12	
4	-12	-9	
5	-9	-6	
6	-6	-3	
7	-3	0	
8	0	15	

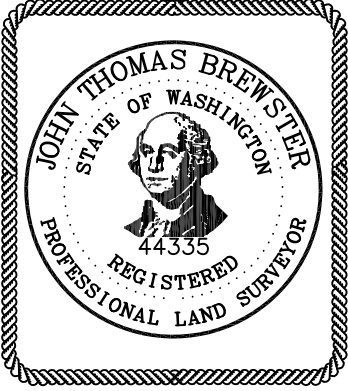

SURVEYOR'S CERTIFICATE

I HEREBY CERTIFY THAT I AM A LICENSED LAND SURVEYOR IN THE STATE OF WASHINGTON, THAT THIS MAP IS BASED ON AN ACTUAL FIELD SURVEY DONE BY ME OR UNDER MY DIRECT SUPERVISION AND THAT ALL DATA SHOWN HEREON ACTUALLY EXISTS IN THE LOCATIONS SHOWN AT THE TIME OF THIS SURVEY. THIS TOPOGRAPHIC MAP WAS DONE AT THE REQUEST OF LAGOON POINT COMMUNITY ASSOCIATION IN 2017.

J. THOMAS BREWSTER, P.L.S. NO. 44335 DATE

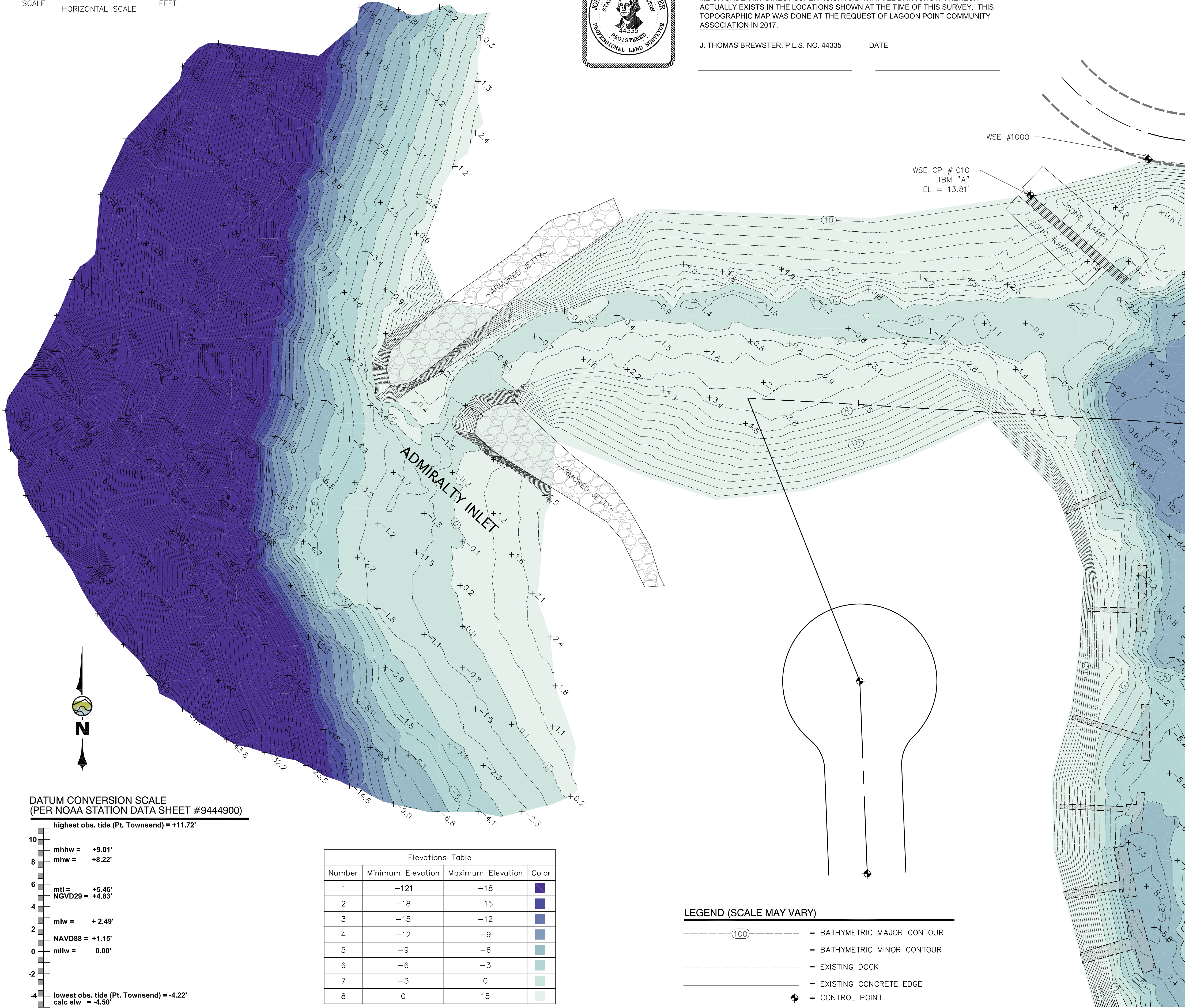

LEGEND (SCALE MAY VARY)

- (100)--- = BATHYMETRIC MAJOR CONTOUR
- --- --- = BATHYMETRIC MINOR CONTOUR
- - - - - = EXISTING DOCK
- ===== = EXISTING CONCRETE EDGE
- ⬮ = CONTROL POINT

WILSON ENGINEERING, LLC
805 DUPONT STREET
BELLINGHAM, WA 98225
(360) 733-6100 • FAX (360) 647-0661
www.wilsonengineering.com

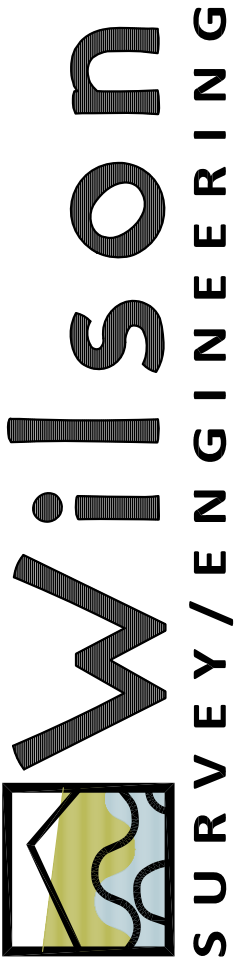

DESIGNED BY
DRAWN BY
CHECKED BY







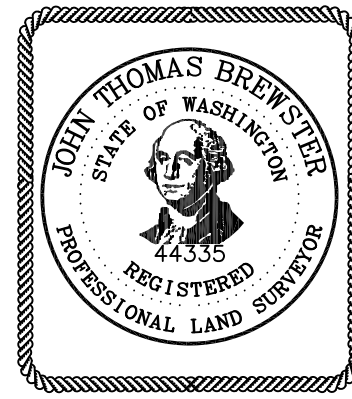

LAGOON POINT COMMUNITY ASSOCIATION
WASHINGTON
GREENBANK
LAGOON POINT MARINA
2017 BATHYMETRIC SURVEY

DATE
SCALE
AS SHOWN
JOB NUMBER

5-9-17
1 OF 10
PAGE
1 OF 10

I HEREBY CERTIFY THAT I AM A LICENSED LAND SURVEYOR IN THE STATE OF WASHINGTON, THAT THIS MAP IS BASED ON AN ACTUAL FIELD SURVEY DONE BY ME OR UNDER MY DIRECT SUPERVISION AND THAT ALL DATA SHOWN HEREON ACTUALLY EXISTS IN THE LOCATIONS SHOWN AT THE TIME OF THIS SURVEY. THIS TOPOGRAPHIC MAP WAS DONE AT THE REQUEST OF LAGOON POINT COMMUNITY ASSOCIATION IN 2017.



Elevations Table			
Number	Minimum Elevation	Maximum Elevation	Color
1	-121	-18	
2	-18	-15	
3	-15	-12	
4	-12	-9	
5	-9	-6	
6	-6	-3	
7	-3	0	
8	0	15	

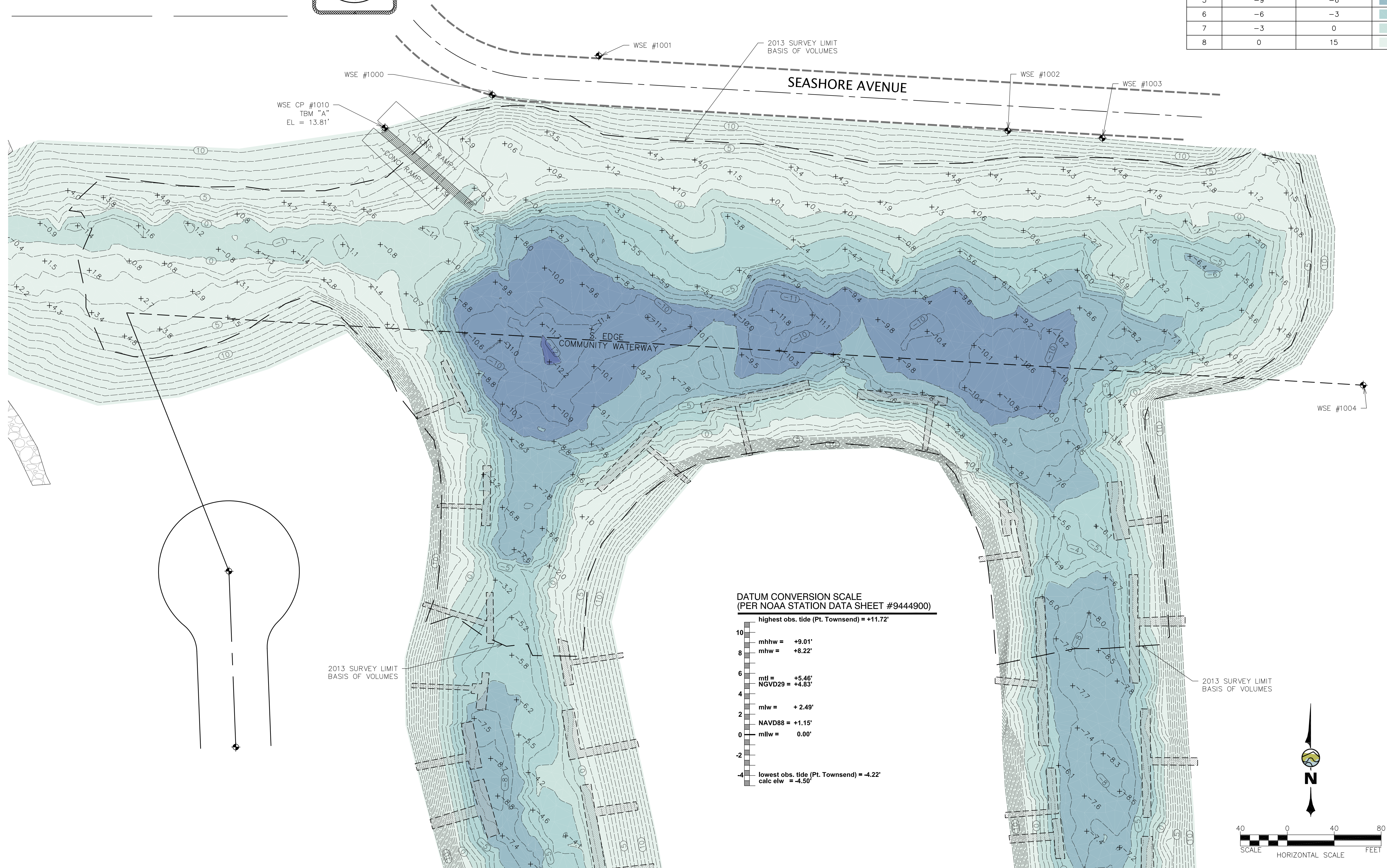

WILSON ENGINEERING, LLC
805 DUPONT STREET
BELLINGHAM, WA 98225
(360) 733-6100 • FAX (360) 647-9061
www.wilsonengineering.com

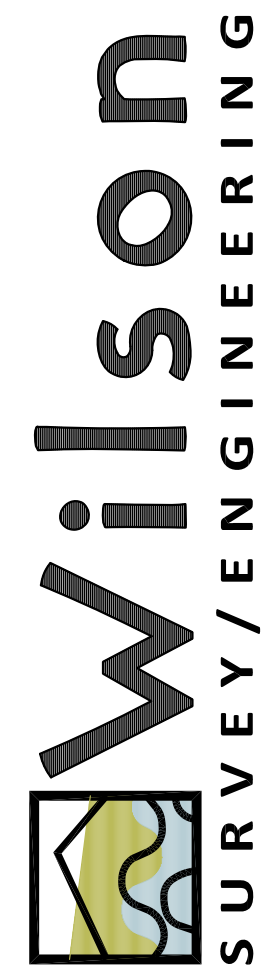

www.wilsonengineering.com

SHEET 2	DATE 5-9-17	LAGOON POINT COMMUNITY ASSOCIATION		DESIGNED BY
	SCALE AS SHOWN JOB NUMBER 2017-031	GREENBANK	WASHINGTON	DRAWN BY JCS
		LAGOON POINT MARINA 2017 BATHYMETRIC SURVEY		CHECKED BY JTB

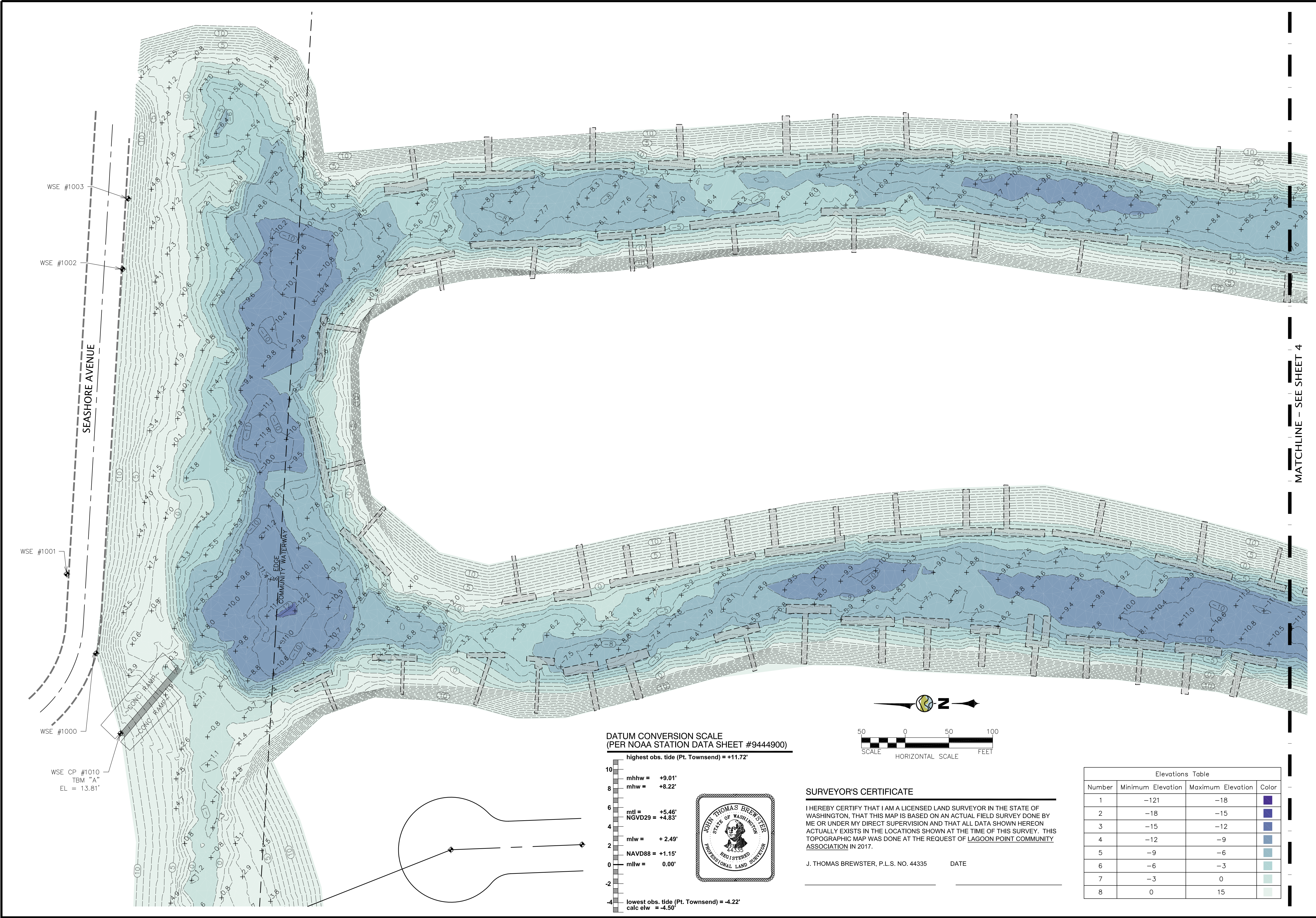

MATCHLINE - SEE SHEET 3

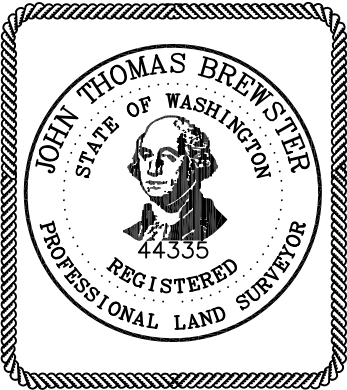
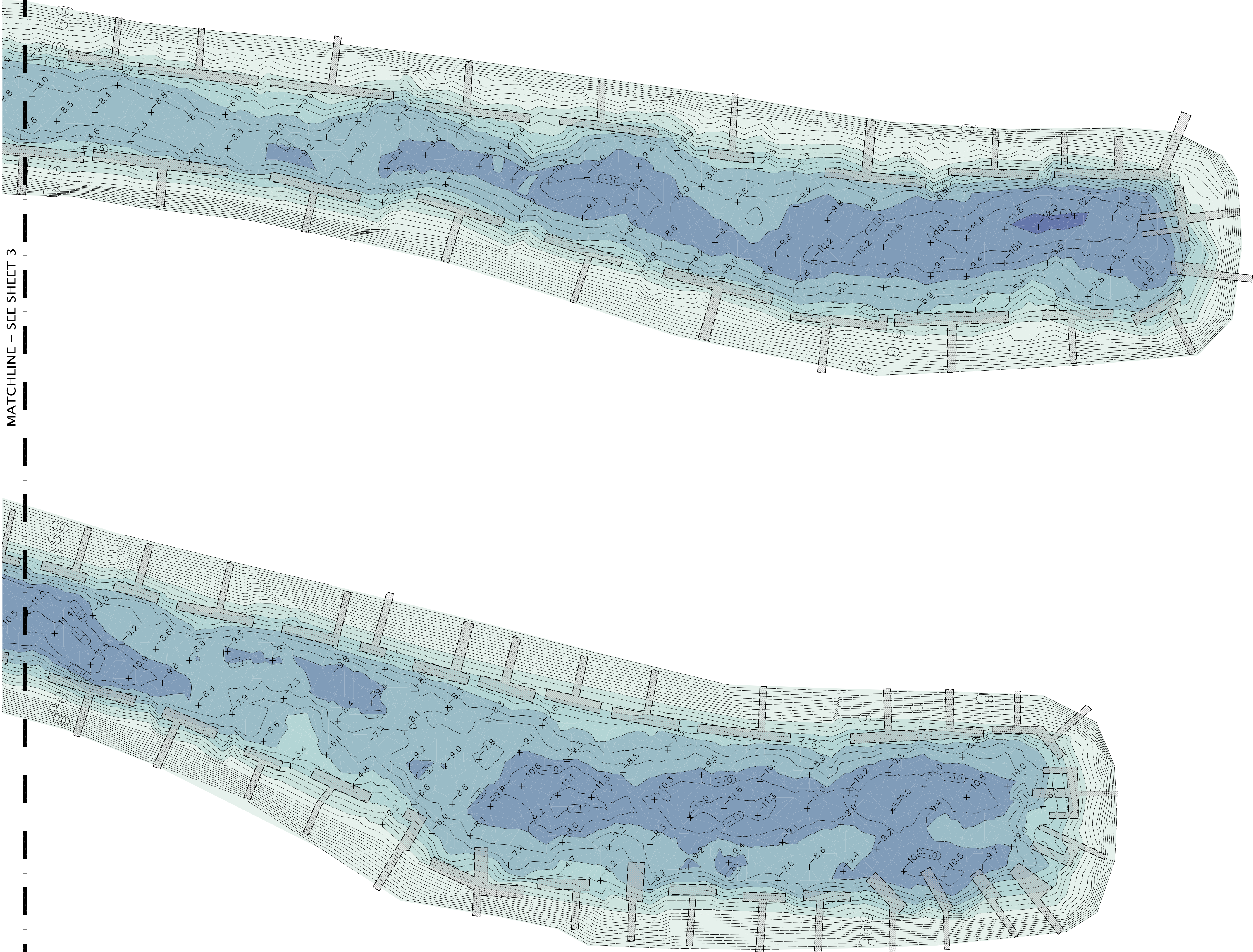

SURVEYOR'S CERTIFICATE

I HEREBY CERTIFY THAT I AM A LICENSED LAND SURVEYOR IN THE STATE OF WASHINGTON, THAT THIS MAP IS BASED ON AN ACTUAL FIELD SURVEY DONE BY ME OR UNDER MY DIRECT SUPERVISION AND THAT ALL DATA SHOWN HEREON ACTUALLY EXISTS IN THE LOCATIONS SHOWN AT THE TIME OF THIS SURVEY. THIS TOPOGRAPHIC MAP WAS DONE AT THE REQUEST OF LAGOON POINT COMMUNITY ASSOCIATION IN 2017.

J. THOMAS BREWSTER, P.L.S. NO. 44335 DATE

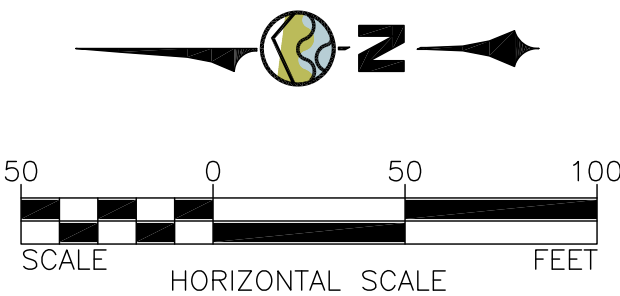

DATUM CONVERSION SCALE
(PER NOAA STATION DATA SHEET #9444900)

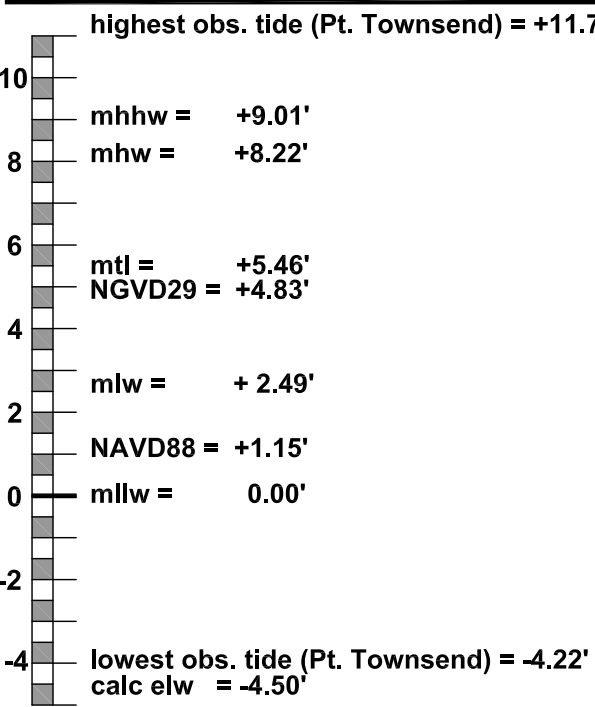

Elevations Table			
Number	Minimum Elevation	Maximum Elevation	Color
1	-121	-18	Dark Purple
2	-18	-15	Dark Blue
3	-15	-12	Medium Blue
4	-12	-9	Light Blue
5	-9	-6	Very Light Blue
6	-6	-3	Lightest Blue
7	-3	0	White
8	0	15	White

WILSON ENGINEERING, LLC
805 DUPONT STREET
BELLINGHAM, WA 98225
(360) 733-6100 • FAX (360) 647-9061
www.wilsonengineering.com

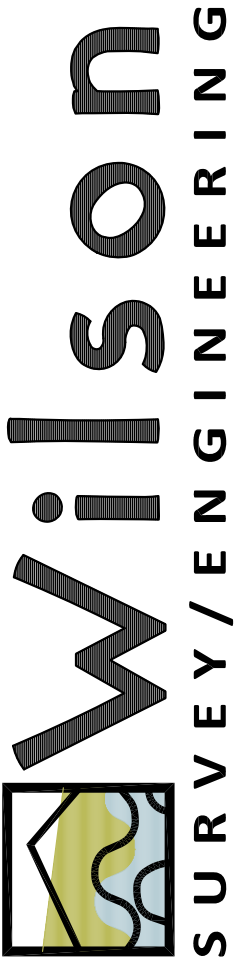

DESIGNED BY
DRAWN BY
CHECKED BY

LAGOON POINT COMMUNITY ASSOCIATION
WASHINGTON
LAGOON POINT MARINA
2017 BATHYMETRIC SURVEY

DATE
SCALE
AS SHOWN
JOB NUMBER

SHEET
4
PAGE
4 OF 10

CONTROL NOTES

1. **HORIZONTAL DATUM:** COORDINATE POSITIONS SHOWN ARE *WASHINGTON STATE PLANE (NORTH ZONE) NAD83/2007* GRID VALUES, BASED UPON HOLDING THE PUBLISHED COORDINATES FOR *ISLAND COUNTY SURVEY CONTROL POINT #1027*, A CAPPED REBAR FLUSH WITH THE GROUND NORTH OF SEASHORE AVENUE APPROXIMATELY 100 FEET EAST OF THE MARINA BOAT LAUNCH, AS EXPRESSED IN THE CURRENT 2007 EPOCH OF NAD83 . THE SURVEY CONTROL POINT WAS SET BY ISLAND COUNTY IN 2007, AND HAS AN ESTIMATED HORIZONTAL AMBIGUITY OF 2CM AND AN ESTIMATED VERTICAL AMBIGUITY OF 5CM. PUBLISHED VALUES HELD FOR THIS SURVEY.

2. **VERTICAL DATUM:** ELEVATIONS SHOWN ARE REFERENCED TO THE *NOAA/TIDAL MLLW = 0.00'* DATUM, BASED UPON HOLDING THE PUBLISHED NAVD88 ELEVATION AT *ISLAND COUNTY SURVEY CONTROL POINT #1027*. CONVERSIONS FROM THE PUBLISHED NAVD88 VALUE TO LOCAL TIDAL (MLLW = 0.00') DERIVED USING THE CURRENT (V. 3.2) VERSDION OF NOAA'S TIDAL-DATUM CONVERSION SOFTWARE "VDATUM" FOR THE PUGET SOUND REGION. VERTICAL CONVERSION FROM *NAVD88 TO MLLW*, PER THE CURRENT MENSURATION IS **+1.15'**. THAT IS, TO CONVERT A VALUE EXPRESSED IN NAVD88 TO ITS VALUE RELATIVE TO THE MLLW DATUM, **1.15 FEET SHOULD BE ADDED TO THE NAVD88 VALUE**. (A MONUMENT HAVING A NAVD88 ELEVATION OF 10.00', WOULD HAVE A MLLW ELEVATION OF 11.15', FOR EXAMPLE.)

3. **BASIS OF COORDINATES:** LOCAL CONTROL AND TOPOGRAPHY IS BASED UPON HOLDING THE CURRENT NAD83(2007) COORDINATE VALUES FOR ISLAND COUNTY SURVEY CONTROL POINT #1027. THE MARK IS A REBAR AND RED PLASTIC CAP SET NORTH OF SEASHORE AVENUE EAST OF THE BOAT LAUNCH RAMP. THE COORDINATES FOR SAID MONUMENT ARE AS FOLLOWS:

NORTHING = 398,690.120 USFT
EASTING = 1,205,853.450 USFT

4. **BASIS OF BEARINGS:** BEARINGS FOR LOCAL CONTROL AND BATHYMETRY ARE *WASHINGTON STATE PLANE (NORTH ZONE) GRID*, BASED UPON HOLDING THE GPS-DERIVED INVERSE BETWEEN ISLAND COUNTY CONTROL POINT #1027, AND WILSON CONTROL POINT #1004 , A CASED BRASS DISK MONUMENT MARKING THE SUBDIVISIONAL LINE BETWEEN THE LAGOON POINT PLATS, AND THE SOUTH LINE OF THE LAGOON POINT COMMUNITY WATERWAY. PER CURRENT RTK/VRS MEASUREMENT THE DERIVED INVERSE BEARING BETWEEN *ISLAND COUNTY #1027* AND *WSE #1004* IS **S 66°40' 47" E** A DISTANCE OF **709.35 FEET**. THE MEASURED COORDINATES FOR *WSE #1004* ARE AS FOLLOWS:

NORTHING = 398,409.310 USFT
EASTING = 1,206,504.850 USFT

5. **BASIS OF ELEVATIONS:** THE PUBLISHED NAVD88 ELEVATION FOR ISLAND COUNTY *CONTROL POINT #1027* WAS HELD AS AUTHORITATIVE AS PUBLISHED. NAVD88 ELEVATION AND CONVERSIONS PER VDATUM FOR #1027 ARE AS FOLLOWS:
NAVD88 ELEVATION: 10.97 FEET
MLLW ELEVATION: 12.12 FEET
NGVD29 ELEVATION: 7.29 FEET

6. **SITE BENCHMARKS:**
TBM "A": WILSON CONTROL POINT #1010, AN IRON TABLET NEAR THE TOP OF THE CONCRETE BOAT LAUNCH STAMPED "ELEV. = 10.41". PER WILSON CLOSED LEVEL LOOP, THE *MLLW* ELEVATION AT CONTROL POINT #1010 IS: **13.81 FEET**. (THE NAVD88 ELEVATION FOR #1010 IS 12.66 FEET.)
TBM "B": A BERNTSEN SURVEY SPIKE SET IN THE EAST SIDE OF THE SOUTHERNMOST PILING AT THE BOAT LAUNCH FLOAT PER WILSON CLOSED LEVEL LOOP, THE *MLLW* ELEVATION AT TBM "B" IS: **14.86 FEET**. (THE NAVD88 ELEVATION FOR TBM "B" IS 13.71 FEET.)

SURVEY NOTES

1. THE SURVEY HEREON DEPICTED WAS PERFORMED IN MARCH, 2017, AND WAS PREPARED AT THE REQUEST OF THE LAGOON POINT HOOMEOWNERS' ASSOCIATION AND THE LAGOON POINT ARCHITECTURAL COMMITTEE. IT IS INTENDED TO ACCURATELY CHARACTERIZE THE BATHYMETRIC CONTOURS AND FEATURES OF THREE (3) DISTINCT ELEMENTS, BEING THE ENTRANCE CHANNEL FROM ADMIRALTY INLET, THE RECENTLY-DREDGED MAIN BASIN, AND THE TWO CHANNELS LYING SOUTH OF THE COMMUNITY WATERWAY LINE. WITHIN THE SCOPE OF THE TWO SOUTH CHANNELS, DATA WAS COLLECTED ASSIDUOUSLY BETWEEN THE CHANNEL-SIDE FACES OF THE FLOATING DOCKS, AND INFREQUENTLY FROM THAT FACE SHOREWARD.

2. SHEETS NO. 2 AND NO.6 DEPICT THE 2013 "COMPARISON SURFACE LIMIT" FROM WHICH VOLUMETRIC CHANGE HAS BEEN CALCULATED. THIS LINE REPRESENTS THE LIMIT OF THE BATHYMETRIC SURFACE PREPARED IN 2013 ACCORDING TO THE "13134SV00-POST DREDGE", DRAWING PREPARED BY WILSON FOR THE LAGOON POINT HOOMEOWNERS' ASSOCIATION. THE VOLUME COMPARISON OF THE PREVIOUS, AND CURRENT, SURFACES SHOWS A NET FILL FOR THE STUDY AREA OF **+2,820 (RAW) CUBIC YARDS, +/- 715 CUBIC YARDS**.

3. THIS SURVEY MEETS OR EXCEEDS THE METHODOLOGY AND ACCURACY REQUIREMENTS FOR A U.S.A.C.E CLASS I HYDROGRAPHIC SURVEY. HYDROGRAPHIC/BATHYMETRIC DATA WAS COLLECTED USING *TRIMBLE 5700* SURVEY-GRADE GPS RECEIVERS OPERATING IN REAL-TIME KINEMATIC MODE, FOR CONTROL OF POSITION, HEADING, AND TRANSDUCER ELEVATION. DEPTH SOUNDINGS WERE ACQUIRED USING AN *OHMEX SONARMITE* SURVEY-GRADE FATHOMETER OPERATING AT A FREQUENCY OF 210khz, WITH A 2hz SAMPLE RATE. SOUND VELOCITY CORRECTIONS FOR THE WATER COLUMN WERE RECORDED USING A *VALEPORT SOUNDBAR II* SOUND VELOCITY PROFILER. HYDROGRAPHIC DATA WAS COMPILED, ANALYZED, VALIDATED, AND THINNED USING HYPACK 2012A HYDROGRAPHIC MAPPING SOFTWARE. FINAL ADJUSTMENTS TO CORRECT FOR TRANSDUCER REFERENCE FACTOR, AND CONVERSION TO MLLW DATUM WERE PERFORMED USING *CIVIL3D* CIVIL ENGINEERING SOFTWARE. SPOT ELEVATIONS SHOWN ON THIS MAP REPRESENT APPROXIMATELY 4% OF THE DATA ORIGINALLY COLLECTED, AND APPROXIMATELY 40% OF THE DATA POINTS USED TO GENERATE THE "EXISTING CONDITIONS" SURFACE FOR VOLUME CALCULATIONS.

4. QUALITY CONTROL BARCHECKS FOR THIS SURVEY WERE PERFORMED AT THE BEGINNING AND END OF SURVEY DATA COLLECTION. DIRECT-MEASURE GROUND TRUTH AS MEASURED AGAINST CONVERTED SOUNDING DATA WAS COLLECTED AT A VARIETY OF DEPTHS, AND LOCATIONS. VARIATION BETWEEN CONVENTIONAL ASBUILT VALUE AND BATHYMETRIC SURVEY DATA WAS FOUND TO BE LESS THAN OR EQUAL TO 0.10'.

5. THIS SURVEY IS INTENDED TO ACCURATELY REPRESENT THE SUBMERGED TOPOGRAPHY WITHIN THE BASINS AND CHANNELS OF THE LAGOON POINT MARINA. DATA WAS COLLECTED IN THE CHANNELS BETWEEN THE WATERWARD FACES OF THE DOCK STRUCTURES AND, WHERE POSSIBLE, BEHIND THE EXTANT DOCKS, HOWEVER, ANY DATA REPRESENTED SHOREWARD OF THE OUTSIDE FACES OF DOCKS SHOULD BE CONSIDERED APPROXIMATE IN CHARACTER, DUE TO SCARCITY OF INFORMATION. THE STRUCTURES DEPICTED HEREON ARE INTENDED TO PROVIDE VISUAL REFERENCE POINTS FOR THE CONTOUR INFORMATION, BUT ARE NOT AN AUTHORITATIVE AS-BUILT OF THE STRUCTURES. CONSIDER THE LOCATIONS OF FLOATS, DOCKS, AND RAMPS TO BE SCHEMATIC ONLY.

6. THE LINE SEGREGATING THE PLAT OF LAGOON POINT FROM THE PLAT OF LAGOON POINT No.2-- AND MARKING THE SOUTH MARGIN OF THE LAGOON POINT COMMUNITY WATERWAY-- COMMENCES AT THE POINT #1004, DERIVED BY DIRECT MEASURE OF THE CASED BRASS DISK MONUMENT AT THE CENTERLINE OF SHOREWOOD AVENUE AND SHOWN ON THE FACE OF BOTH PLATS. THE WEST EXTENSION OF SAID WATERWAY LINE WAS CALCULATED USING PLAT VALUE MEASUREMENT FROM TWO FOUND CASED BRASS DISK MONUMENTS NEAR THE NORTH CUL-DE-SAC OF OCEAN SIDE DRIVE, AS SHOWN ON THE PLAT OF LAGOON POINT No.2.

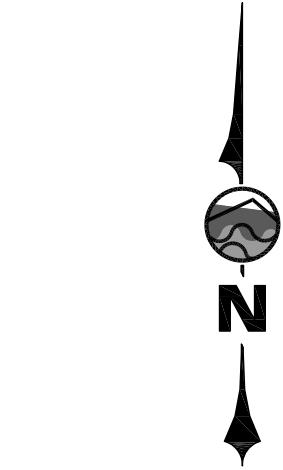

DATUM CONVERSION SCALE
(PER NOAA STATION DATA SHEET #9444900)

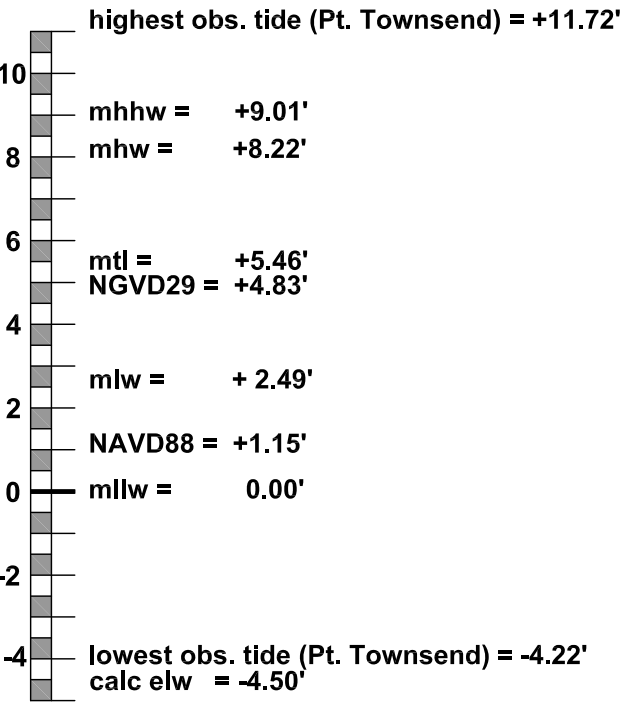

LEGEND (SCALE MAY VARY)

- 100--- = BATHYMETRIC MAJOR CONTOUR
- = BATHYMETRIC MINOR CONTOUR
- = EXISTING DOCK
- = EXISTING CONCRETE EDGE
- = CONTROL POINT

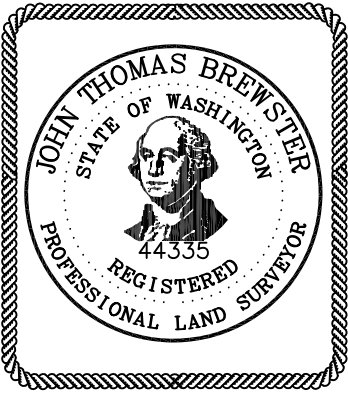

SURVEYOR'S CERTIFICATE

I HEREBY CERTIFY THAT I AM A LICENSED LAND SURVEYOR IN THE STATE OF WASHINGTON, THAT THIS MAP IS BASED ON AN ACTUAL FIELD SURVEY DONE BY ME OR UNDER MY DIRECT SUPERVISION AND THAT ALL DATA SHOWN HEREON ACTUALLY EXISTS IN THE LOCATIONS SHOWN AT THE TIME OF THIS SURVEY. THIS TOPOGRAPHIC MAP WAS DONE AT THE REQUEST OF LAGOON POINT COMMUNITY ASSOCIATION IN 2017.

J. THOMAS BREWSTER, P.L.S. NO. 44335 DATE

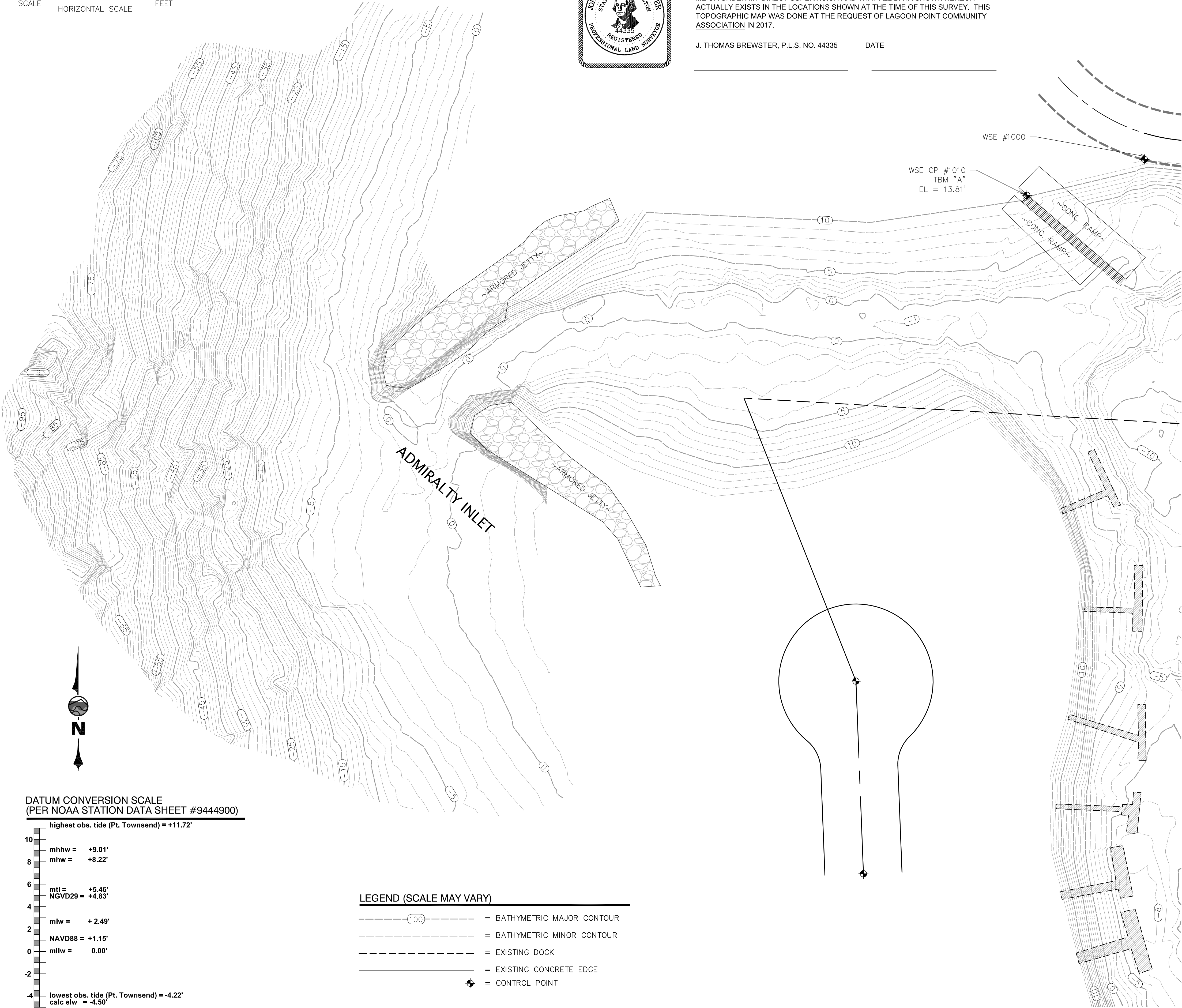

WILSON ENGINEERING, LLC
805 DUPONT STREET
BELLINGHAM, WA 98225
(360) 733-6100 • FAX (360) 647-0661
www.wilsonengineering.com

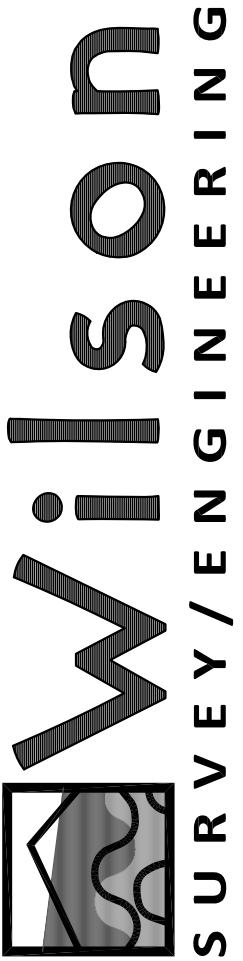

SHEET	DATE	LAGOON POINT COMMUNITY ASSOCIATION		
		GREENBANK	WASHINGTON	
5	5-9-17	LAGOON POINT MARINA		
		2017 BATHYMETRIC SURVEY		
PAGE	SCALE	AS SHOWN	JCS	JTB
5	OF 10			

I HEREBY CERTIFY THAT I AM A LICENSED LAND SURVEYOR IN THE STATE OF WASHINGTON, THAT THIS MAP IS BASED ON AN ACTUAL FIELD SURVEY DONE BY ME OR UNDER MY DIRECT SUPERVISION AND THAT ALL DATA SHOWN HEREON ACTUALLY EXISTS IN THE LOCATIONS SHOWN AT THE TIME OF THIS SURVEY. THIS TOPOGRAPHIC MAP WAS DONE AT THE REQUEST OF LAGOON POINT COMMUNITY ASSOCIATION IN 2017.

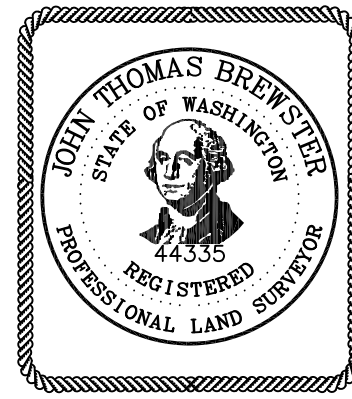

NOTE:
SEE SHEETS 9 & 10 FOR SECTION VIEWS

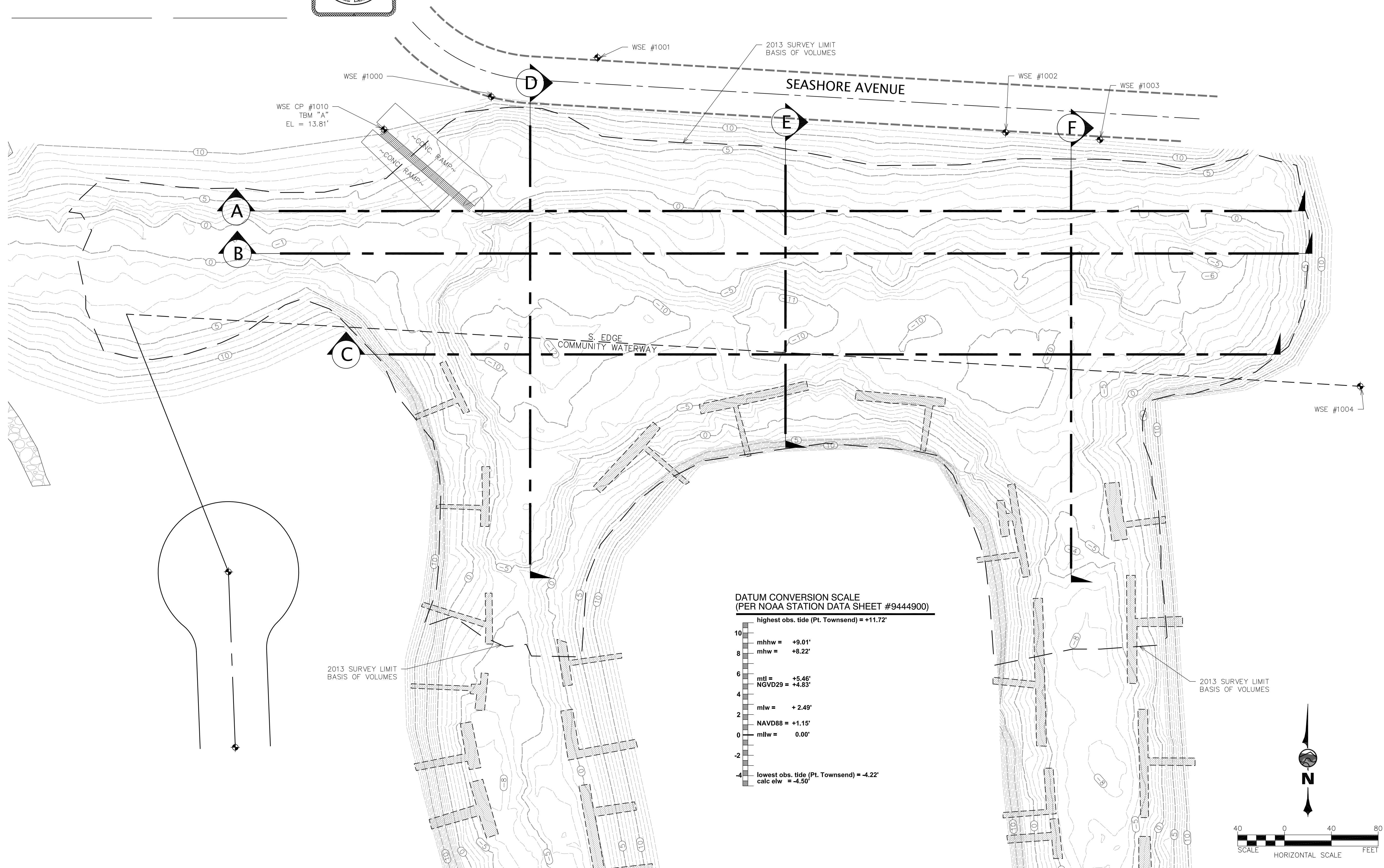

WILSON ENGINEERING, LLC
805 DUPONT STREET
BELLINGHAM, WA 98225
(360) 733-6100 • FAX (360) 647-9061

www.wilsonengineering.com

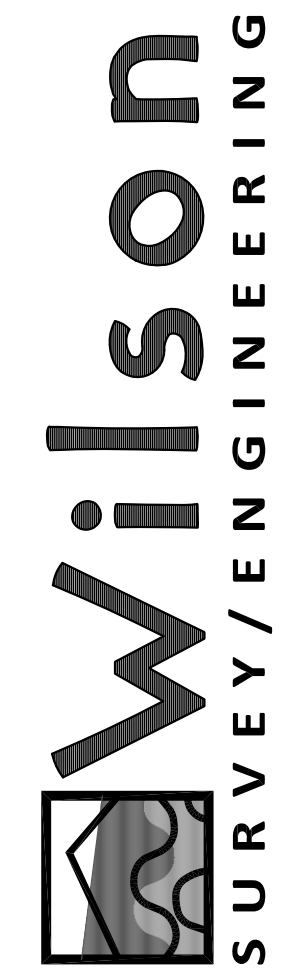

SHEET 6	DATE 5-9-17	LAGOON POINT COMMUNITY ASSOCIATION		DESIGNED BY
	SCALE AS SHOWN			WASHINGTON
PAGE 6 of 10	JOB NUMBER 2017-031	LAGOON POINT MARINA 2017 BATHYMETRIC SURVEY		CHECKED BY JTB

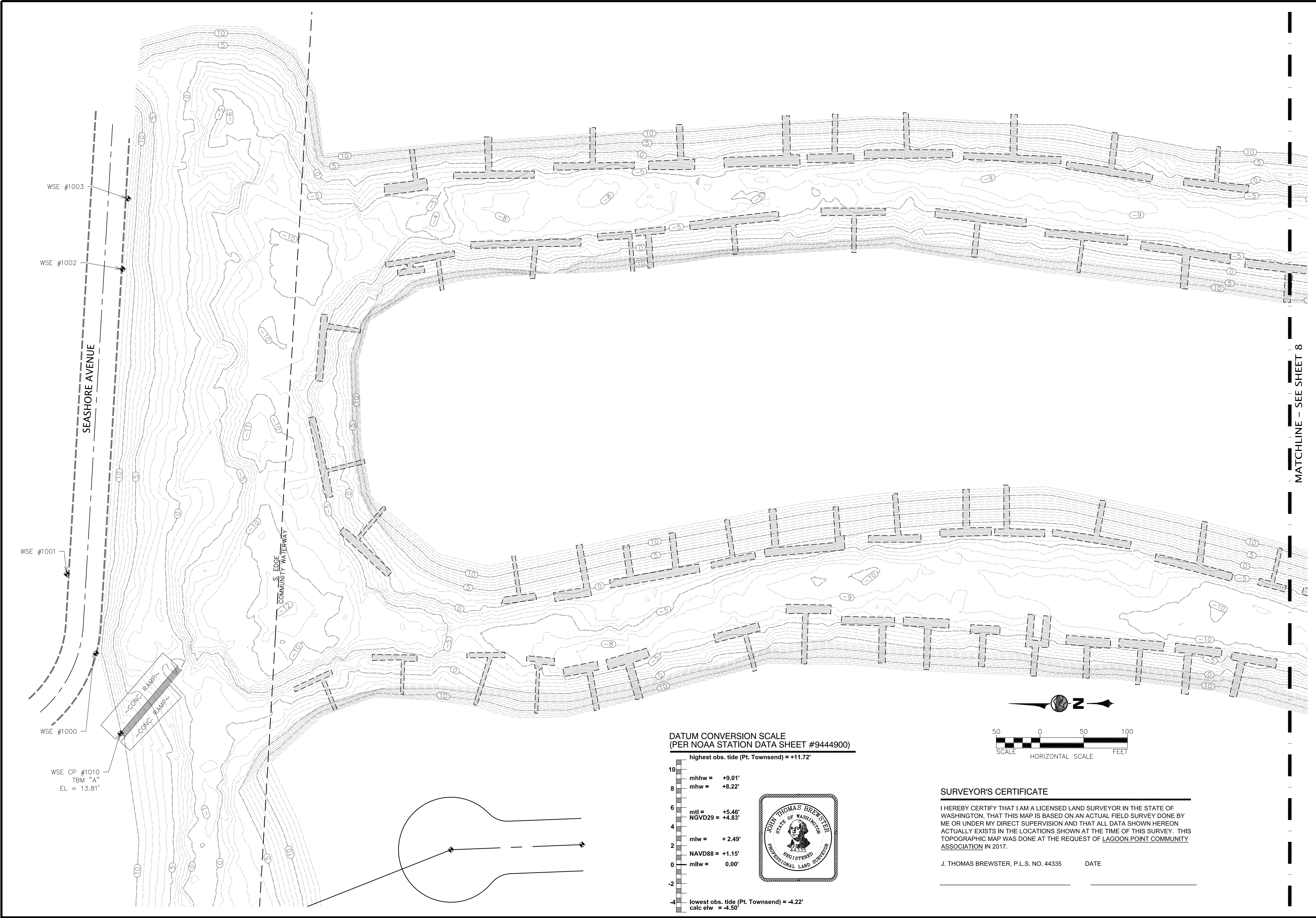

MATCHLINE - SEE SHEET 7

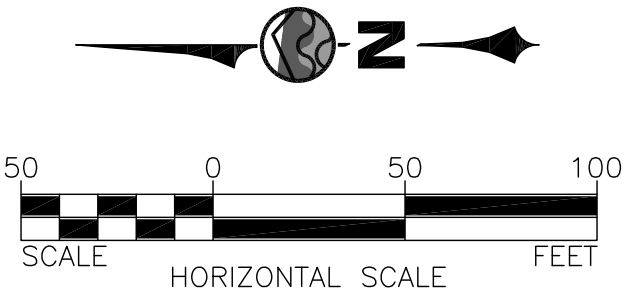
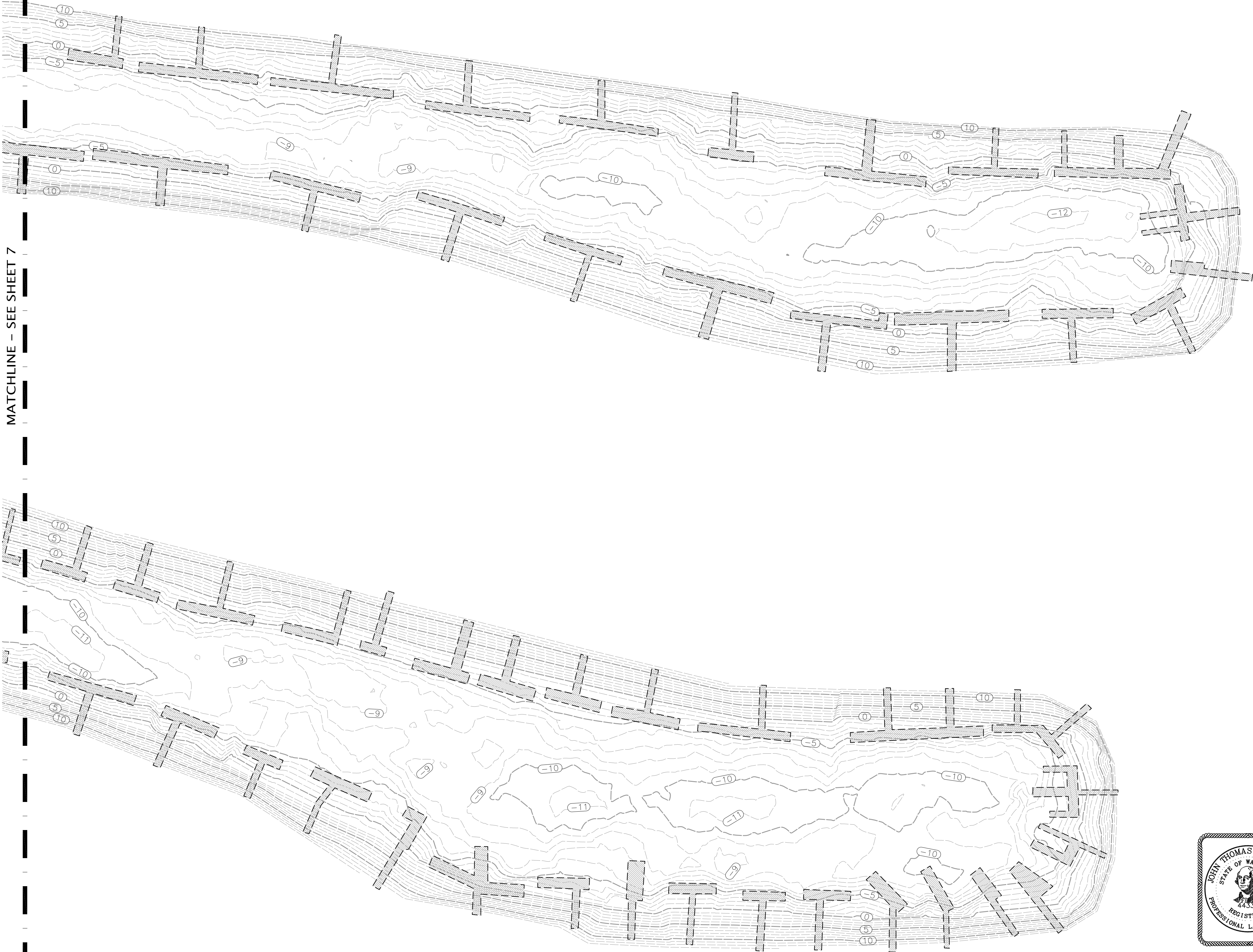

DATUM CONVERSION SCALE
(PER NOAA STATION DATA SHEET #9444900)

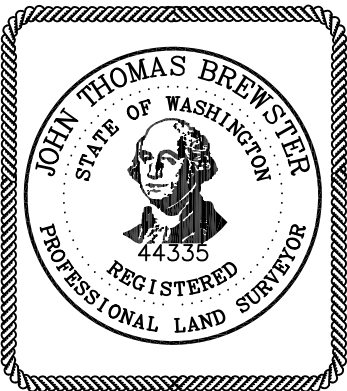
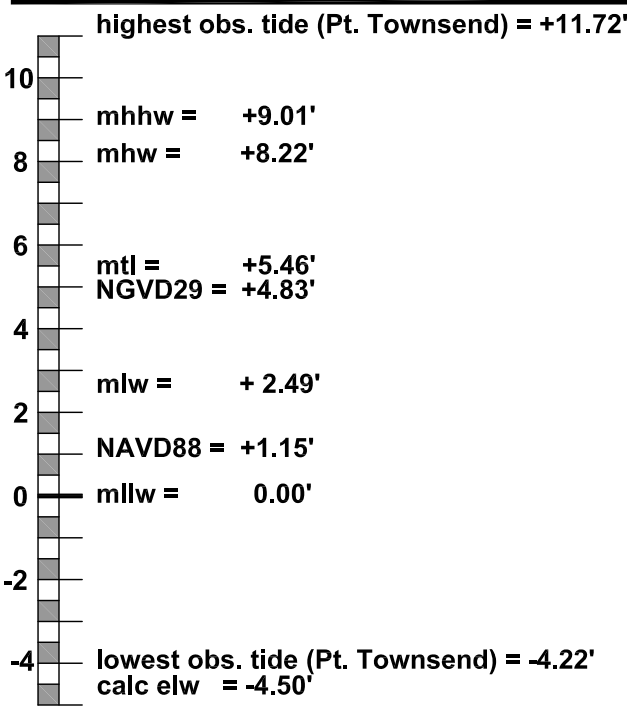

SURVEYOR'S CERTIFICATE

I HEREBY CERTIFY THAT I AM A LICENSED LAND SURVEYOR IN THE STATE OF WASHINGTON, THAT THIS MAP IS BASED ON AN ACTUAL FIELD SURVEY DONE BY ME OR UNDER MY DIRECT SUPERVISION AND THAT ALL DATA SHOWN HEREON ACTUALLY EXISTS IN THE LOCATIONS SHOWN AT THE TIME OF THIS SURVEY. THIS TOPOGRAPHIC MAP WAS DONE AT THE REQUEST OF LAGOON POINT COMMUNITY ASSOCIATION IN 2017.

J. THOMAS BREWSTER, P.L.S. NO. 44335 DATE

WILSON ENGINEERING, LLC
805 DUPONT STREET
BELLINGHAM, WA 98225
(360) 733-6100 • FAX (360) 647-9061
www.wilsonengineering.com

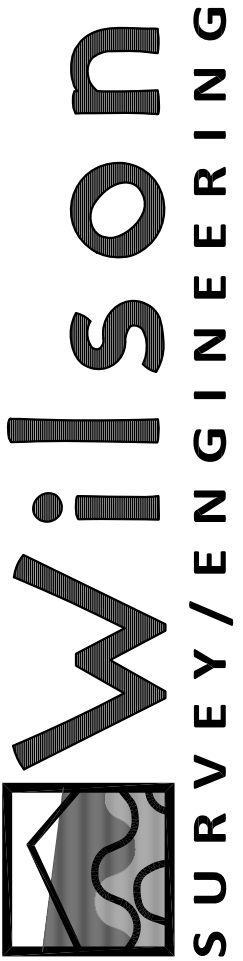

LAGOON POINT COMMUNITY ASSOCIATION

GREENBANK WASHINGTON

LAGOON POINT MARINA
2017 BATHYMETRIC SURVEY

DATE
5-9-17

SCALE
AS SHOWN

JOB NUMBER
2017-031

SHEET
8

PAGE
8 OF 10

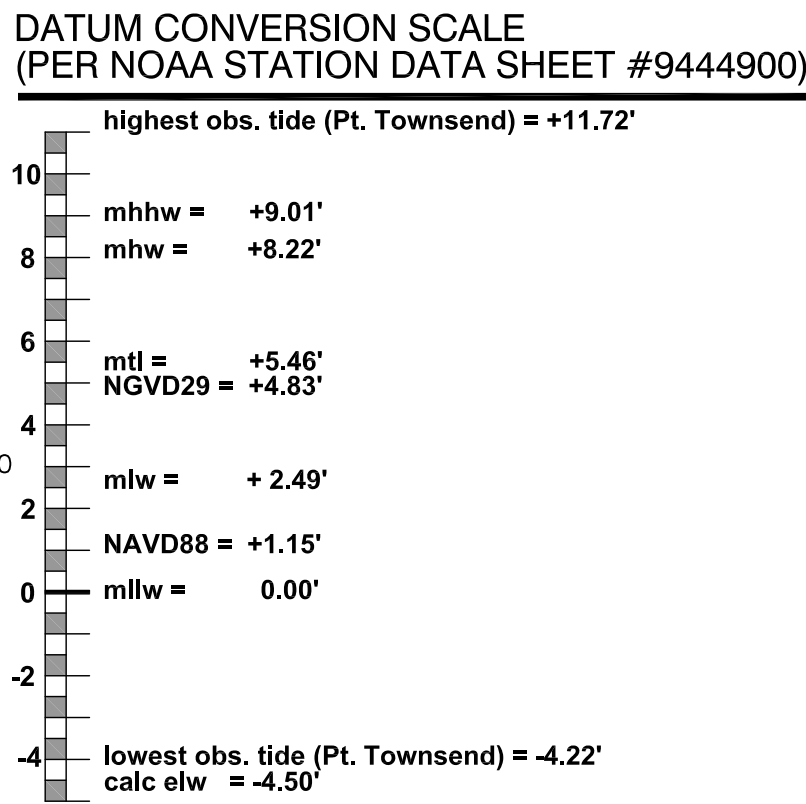
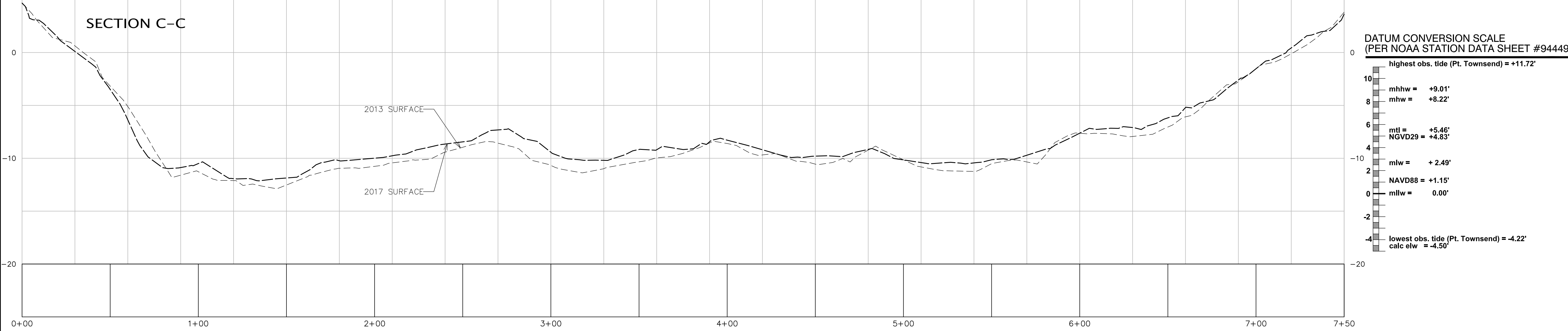
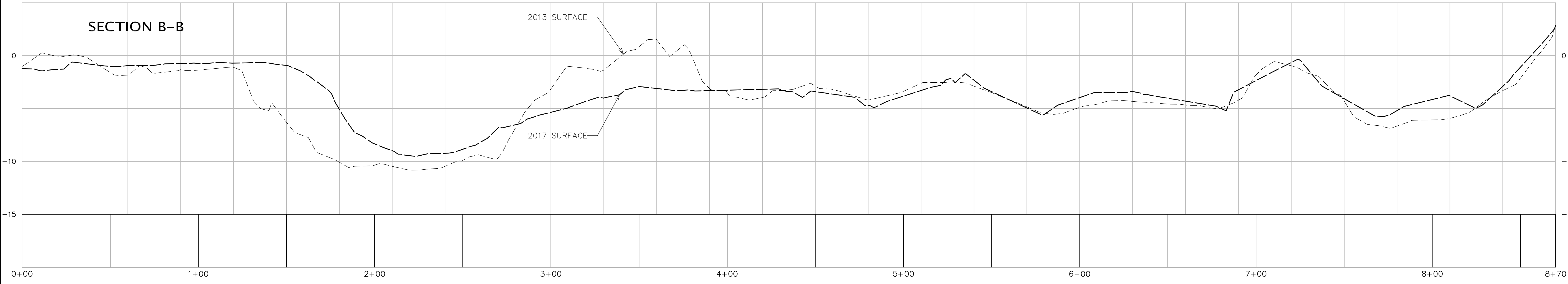
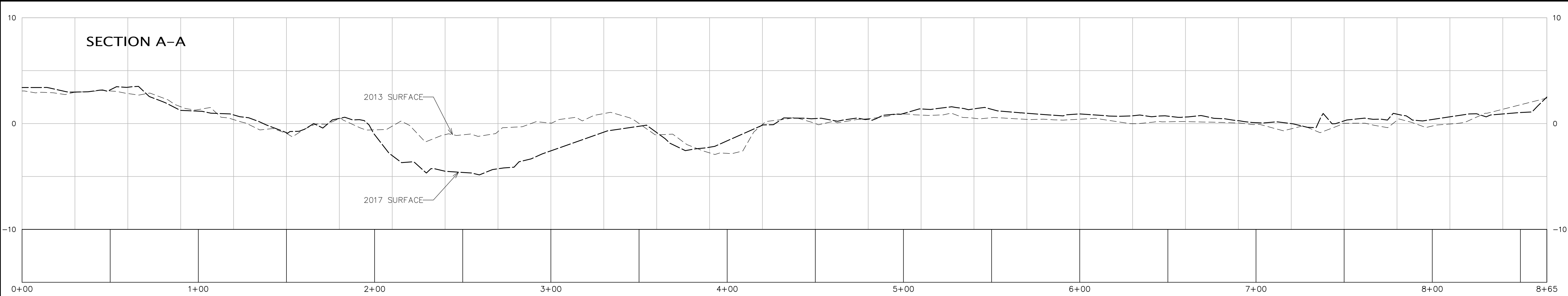

SURVEYOR'S CERTIFICATE

I HEREBY CERTIFY THAT I AM A LICENSED LAND SURVEYOR IN THE STATE OF WASHINGTON, THAT THIS MAP IS BASED ON AN ACTUAL FIELD SURVEY DONE BY ME OR UNDER MY DIRECT SUPERVISION AND THAT ALL DATA SHOWN HEREON ACTUALLY EXISTS IN THE LOCATIONS SHOWN AT THE TIME OF THIS SURVEY. THIS TOPOGRAPHIC MAP WAS DONE AT THE REQUEST OF LAGOON POINT COMMUNITY ASSOCIATION IN 2017.

J. THOMAS BREWSTER, P.L.S. NO. 44335

DATE

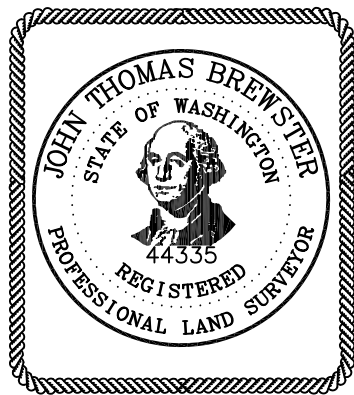

WILSON ENGINEERING, LLC
805 DUPONT STREET
BELLINGHAM, WA 98225
(360) 733-6100 • FAX (360) 647-9061

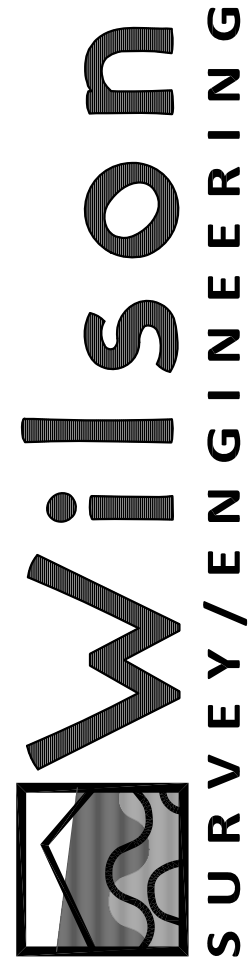

www.wilsonengineering.com

DESIGNED BY

DRAWN BY

CHECKED BY

JCS

JTB

LAGOON POINT COMMUNITY ASSOCIATION

GREENBANK WASHINGTON

LAGOON POINT MARINA

2017 BATHYMETRIC SURVEY – SECTIONS

DATE

5-9-17

SCALE

AS SHOWN

JOB NUMBER

2017-031

SHEET

9

PAGE

9

OF 10

PLOT SETTINGS: Adobe PDF, ANSI D, Landscape, 1:1, WE, APWA_UNSCREENED.ctb
W:\2017\2017-031 LAGOON POINT BATHY-Metric\2017-031SW02_CSM\17-SECTIONS & COMPOSITE SURFACE_JCS.DWG - 5/9/2017 12:35 PM - Alan Moors

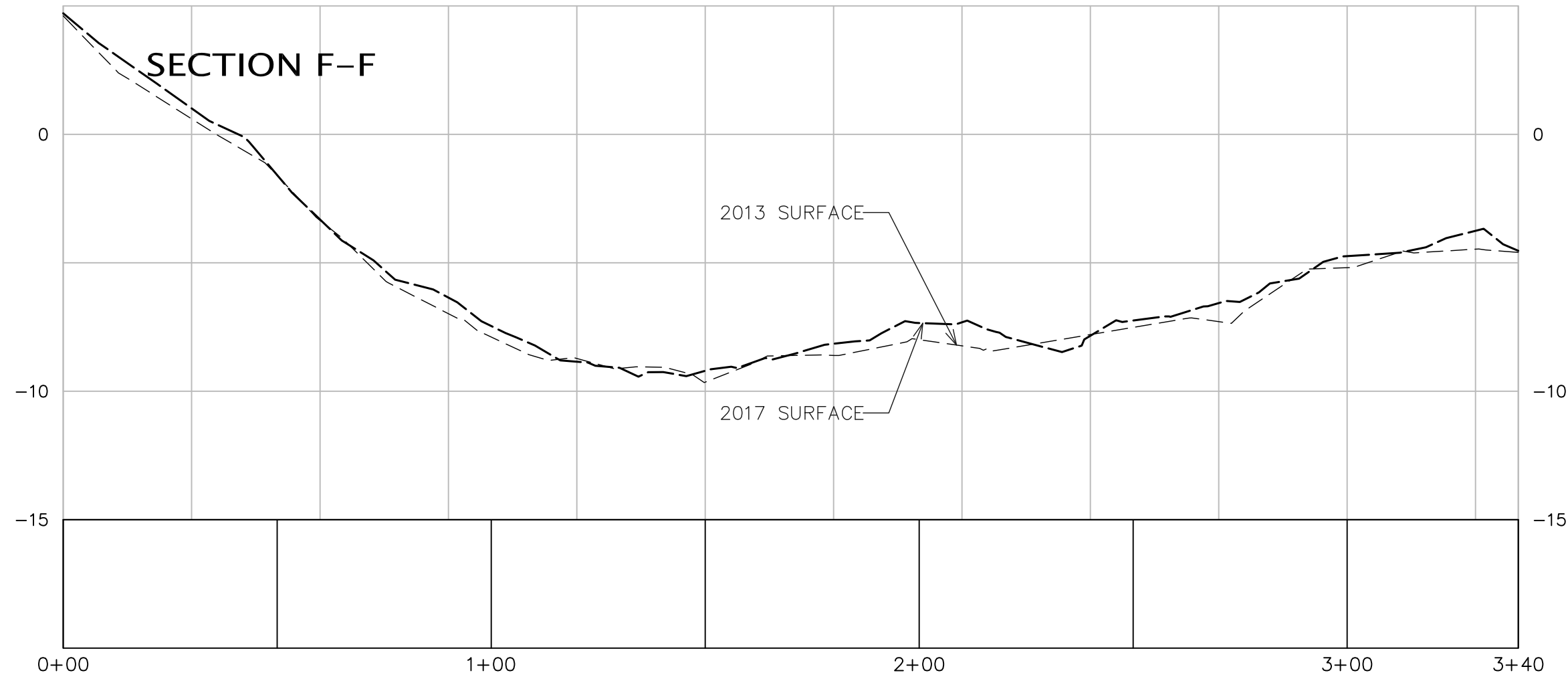
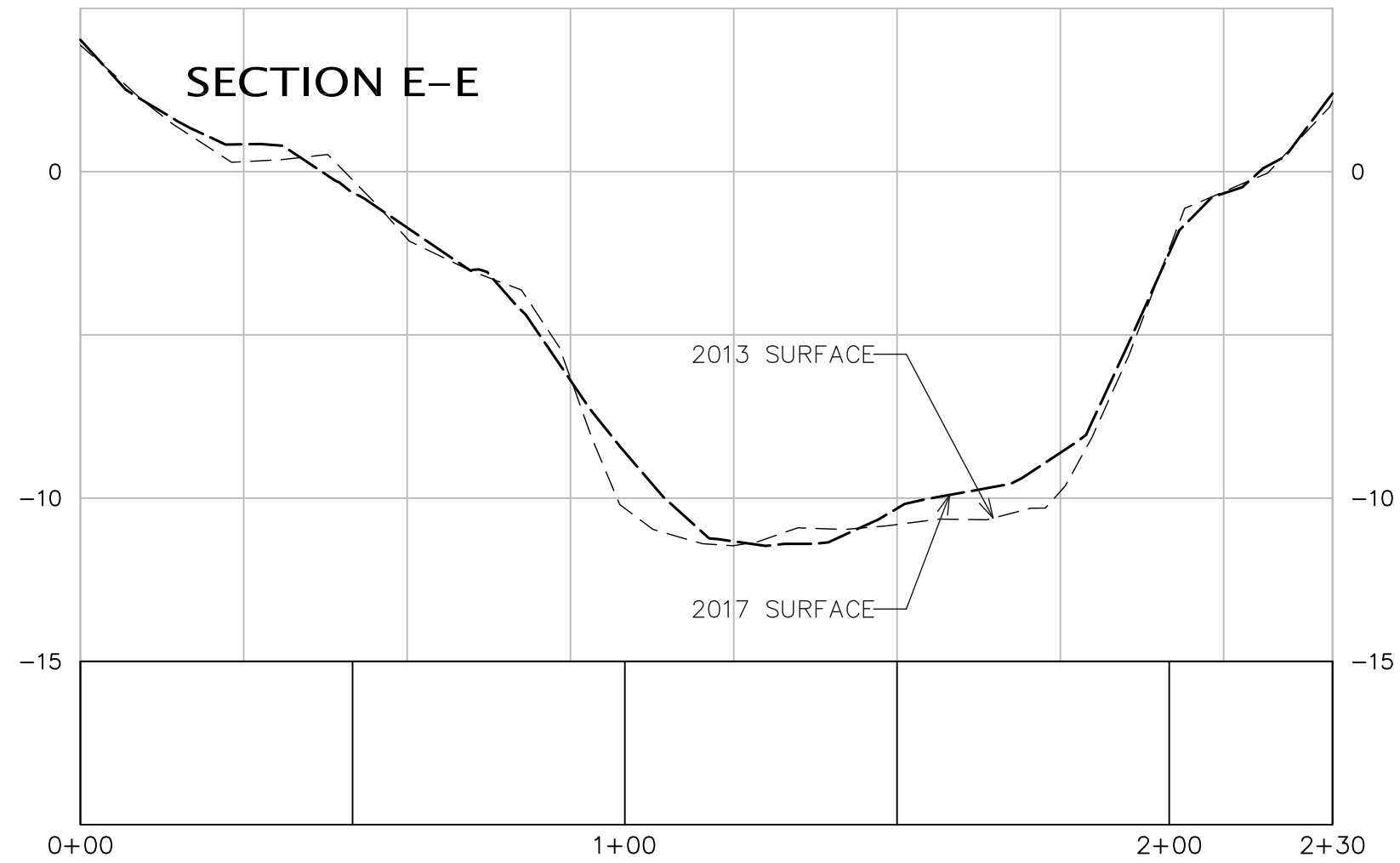
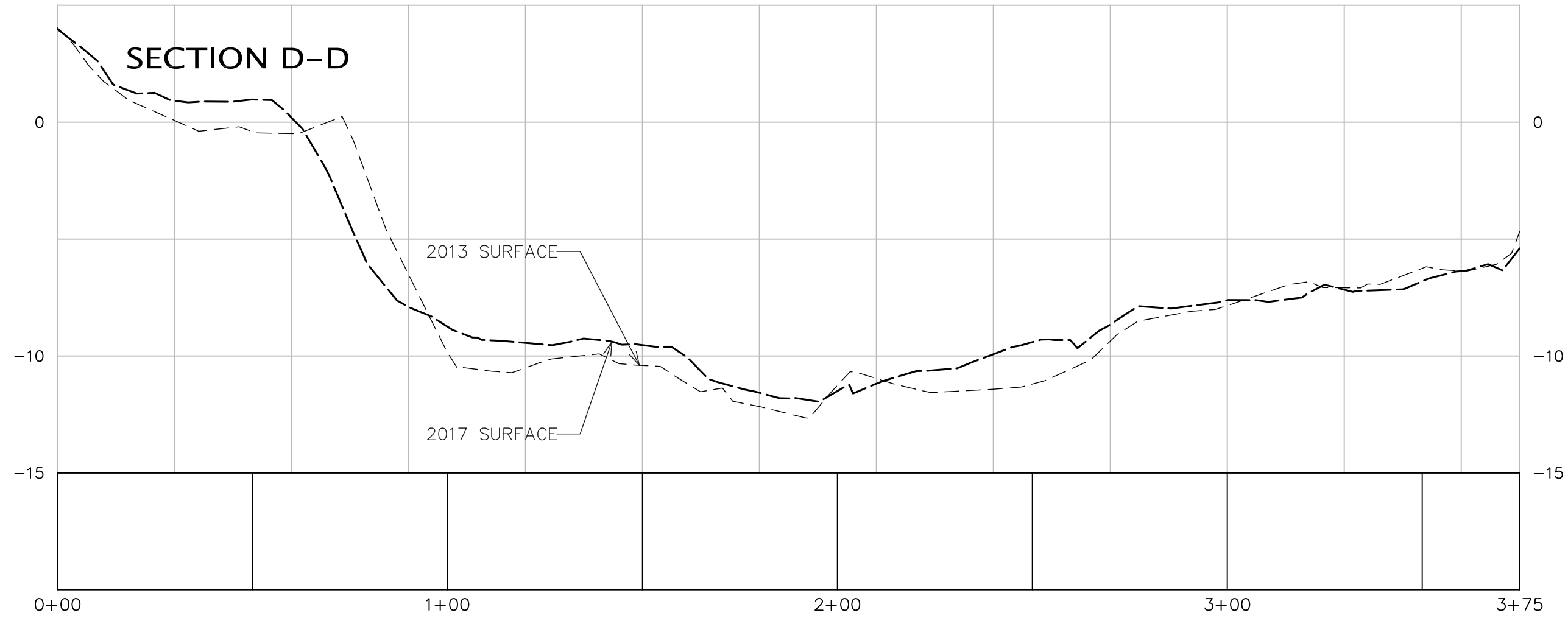

SURVEYOR'S CERTIFICATE

I HEREBY CERTIFY THAT I AM A LICENSED LAND SURVEYOR IN THE STATE OF WASHINGTON, THAT THIS MAP IS BASED ON AN ACTUAL FIELD SURVEY DONE BY ME OR UNDER MY DIRECT SUPERVISION AND THAT ALL DATA SHOWN HEREON ACTUALLY EXISTS IN THE LOCATIONS SHOWN AT THE TIME OF THIS SURVEY. THIS TOPOGRAPHIC MAP WAS DONE AT THE REQUEST OF LAGOON POINT COMMUNITY ASSOCIATION IN 2017.

J. THOMAS BREWSTER, P.L.S. NO. 44335

DATE

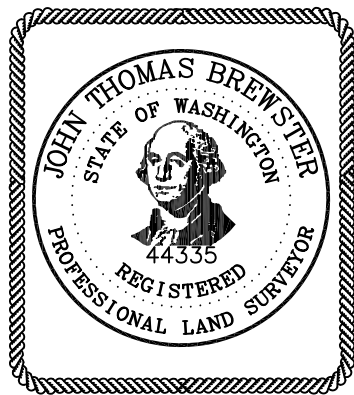

**DATUM CONVERSION SCALE
(PER NOAA STATION DATA SHEET #9444900)**

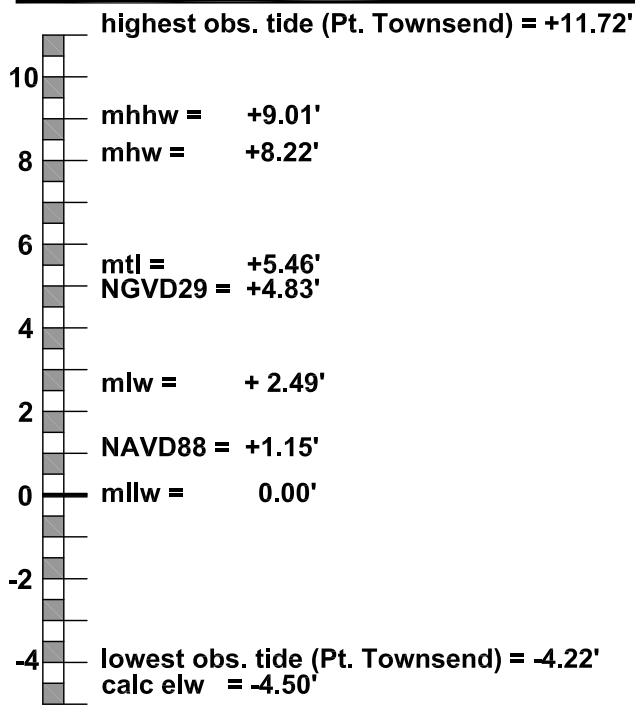

WILSON ENGINEERING, LLC
805 DUPONT STREET
BELLINGHAM, WA 98225
(360) 733-6100 • FAX (360) 647-9061
www.wilsonengineering.com

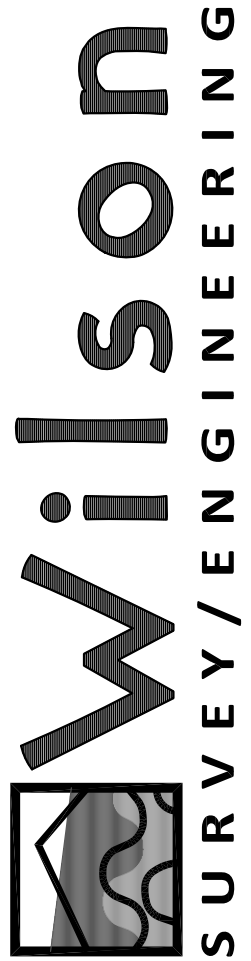

DESIGNED BY

DRAWN BY

CHECKED BY

JCS

JTB

LAGOON POINT COMMUNITY ASSOCIATION

GREENBANK WASHINGTON

LAGOON POINT MARINA

2017 BATHYMETRIC SURVEY – SECTIONS

DATE

5-9-17

SCALE

AS SHOWN

JOB NUMBER

2017-031

SHEET

10

PAGE

10

OF

10